

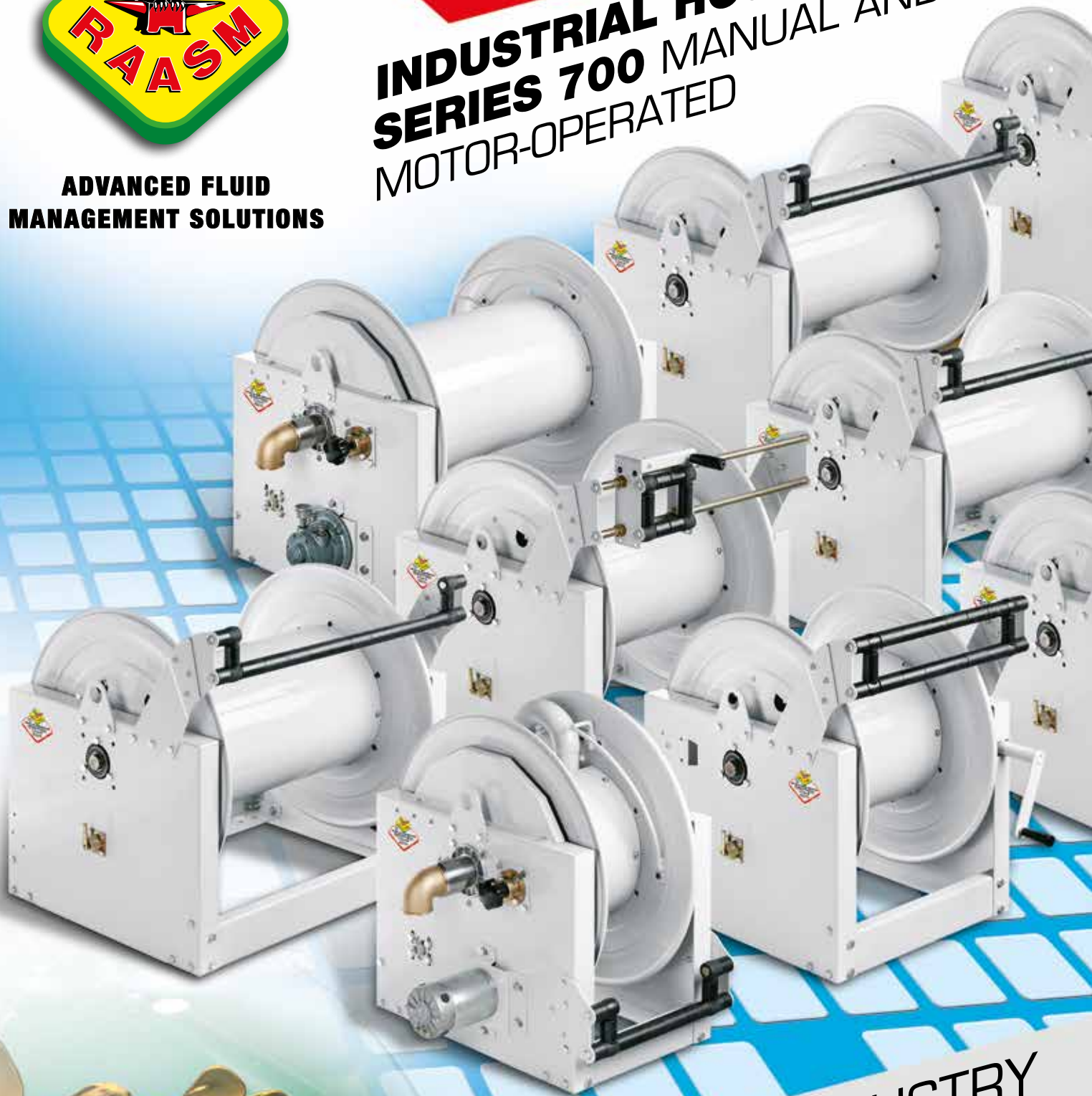

**ADVANCED FLUID
MANAGEMENT SOLUTIONS**

INDUSTRIAL HOSE REELS SERIES 700 MANUAL AND MOTOR-OPERATED



INDISPENSABLE FOR INDUSTRY

No. 220/700





SERIES 700 MANUAL AND MOTOR-OPERATED

PAINTED STEEL



INDEX

Technical characteristics page **4**



Series 700 manual page **6**



Series 700 electric 24V page **8**



Series 700 electric 230V page **9**



Series 700 hydraulic

page **10**



Series 700 pneumatic

page **11**

Accessories

page **12**

Applications

page **14**

▶ Standard open hose guide.
Enables fitting of two guides
in opposite directions (see figure
page 12 below)
Available on request.

▶ Standard closed hose guide.
Available on request.

▶ Manual operation hose guide for
optimum winding of hose.
Available on request.

Version
with 230V
electric
motor.

Manual stop
preventing drum
movement.

The painting is highly resistant to
atmospheric agents and impacts.
The painted products undergo "saline mist
resistance" corrosion testing according to
UNI 9227 standards.

Technical characteristics



The exploded view below enables easy identification of the main parts making up the industrial hose reel, at the same time indicating the technical features.

As well as being **available with drum in 4 different widths**, the various hose reel models differ for:

- **type of motorisation** (manual, 24V electric, 230V electric, hydraulic, pneumatic)
 - 2" swivel joint max. **pressure** (20 bar or 70 bar)
 - **type and position of hose guide** (available on request)
 - **presence or not of the clutch** which regulates the hose unwinding speed.
- All the models have a manual drum stop.

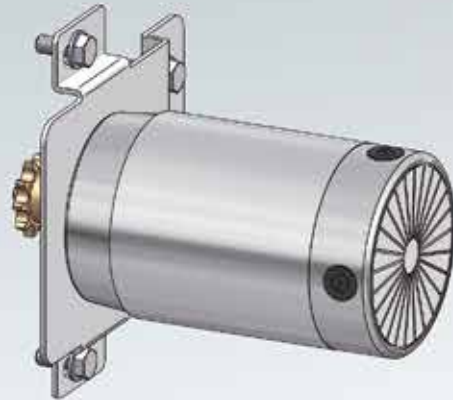

► Version with 24V electric motor.

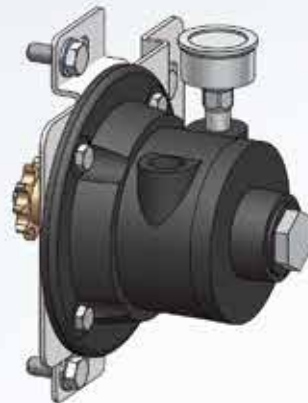

► Version with pneumatic motor.

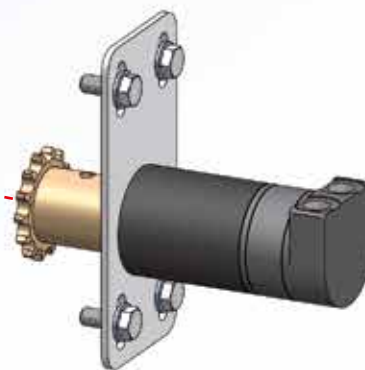

► Version with hydraulic motor.

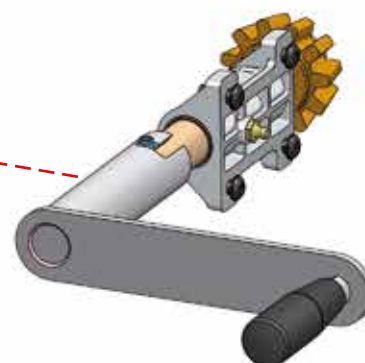

► Version with handle connected to the rack.

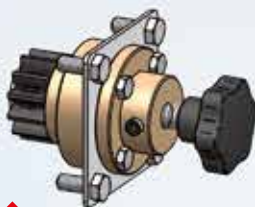

Adjustable clutch for correct hose unwinding.
Available on request.

Swivel joint with total passage so as not to hinder the flow.

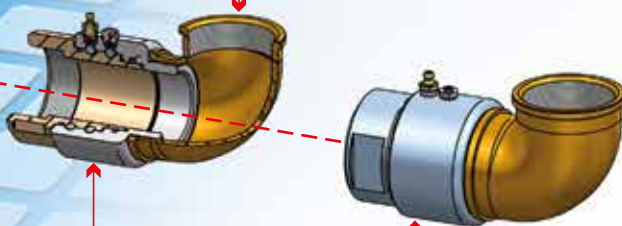

Aluminium
20 bar.

Steel
70 bar.



SERIES 700 MANUAL

PAINTED STEEL

The manual hose reels are a handy and easy answer to the problem of hose management. Given their simple operation, they are practically maintenance free.

In accordance with
directive



	width 270 mm	width 410 mm	width 550 mm	width 690 mm	Connection	
					inlet	outlet
20 bar Air - Water Diesel fuel - swivel joint aluminium - seals in Viton®	7721001.100	7741001.100	7751001.100	7771001.100	2"	2"
70 bar Oil and allied products - swivel joint in carbon steel - seals in Viton®	7721001.400	7741001.400	7751001.400	7771001.400	2"	2"

DRUM CAPACITY					
Ø HOSE	Ø HOSE EXT.	L270	L410	L550	L690
3/8"	17 mm	160 m	290 m	420 m	550 m
1/2"	20 mm	110 m	180 m	280 m	350 m
3/4"	27 mm	65 m	120 m	180 m	244 m
1"	34 mm	30 m	60 m	100 m	134 m
1.1/4"	43 mm	20 m	35 m	60 m	84 m
1.1/2"	50 mm	15 m	30 m	50 m	75 m
2"	63 mm	10 m	20 m	30 m	43 m

OVERALL DIMENSIONS

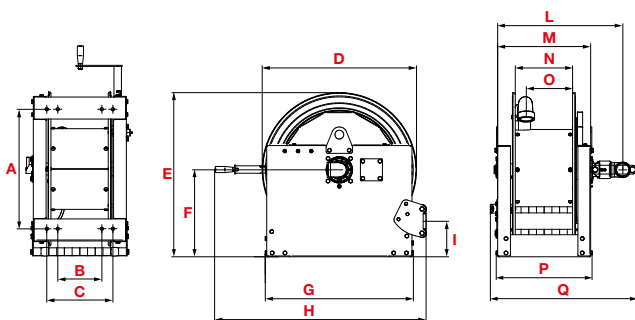

Manual hose reel

The practical handle, connected to the external rack allows easy winding of the hose at the same time controlling its positioning on the drum. **There is also an easy allocation where the handle can be stored during the un-winding operation.**

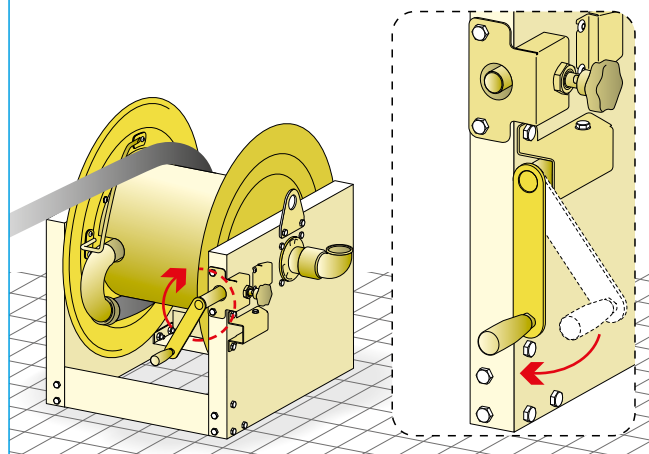

P/N	A	B	C	D	E	F	G	H	I	L	M	N	O	P	Q	1-m³	Kg
L 270	542	200	300	700	760	410	672	920	160	570	422	260	210	435	640	0,53	85
L 410	542	340	440	700	760	410	672	920	160	712	562	398	350	575	735	0,63	96
L 550	542	480	580	700	760	410	672	920	160	850	705	538	490	717	875	0,73	103
L 690	542	620	720	700	760	410	672	920	160	990	842	680	630	855	1060	0,82	119



Technical characteristics handle - clutch

Position of handle with clutch

The clutch is indispensable for regulating the hose unwinding speed and preventing the drum from turning empty due to inertia. The hose reel comes with the winding handle and clutch in the standard position as shown in the photo opposite.

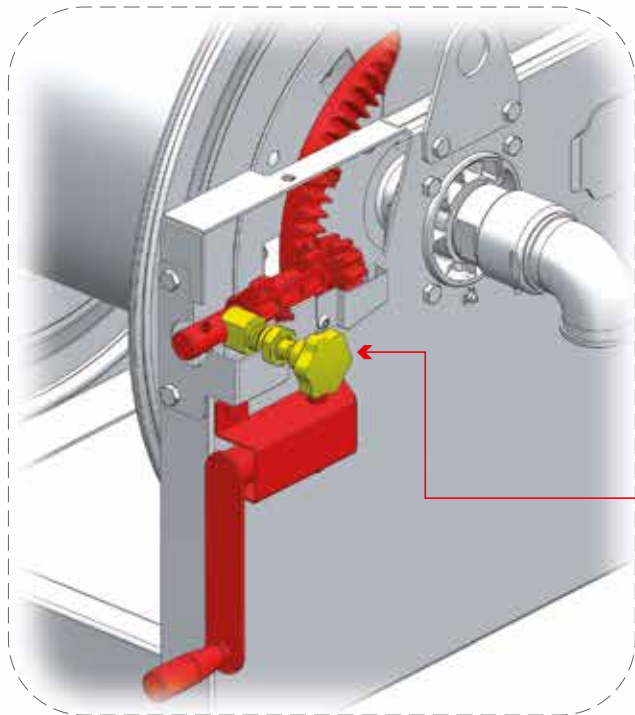

The clutch in POM, which acts on the handle (to be used only during unwinding), creates the necessary friction on the pinion, for regulating hose unwinding speed.



Shifting the handle with clutch

If required by hose reel use, the handle and clutch can be shifted from the standard position indicated above to the position shown in the figure opposite, by means of two simple operations.

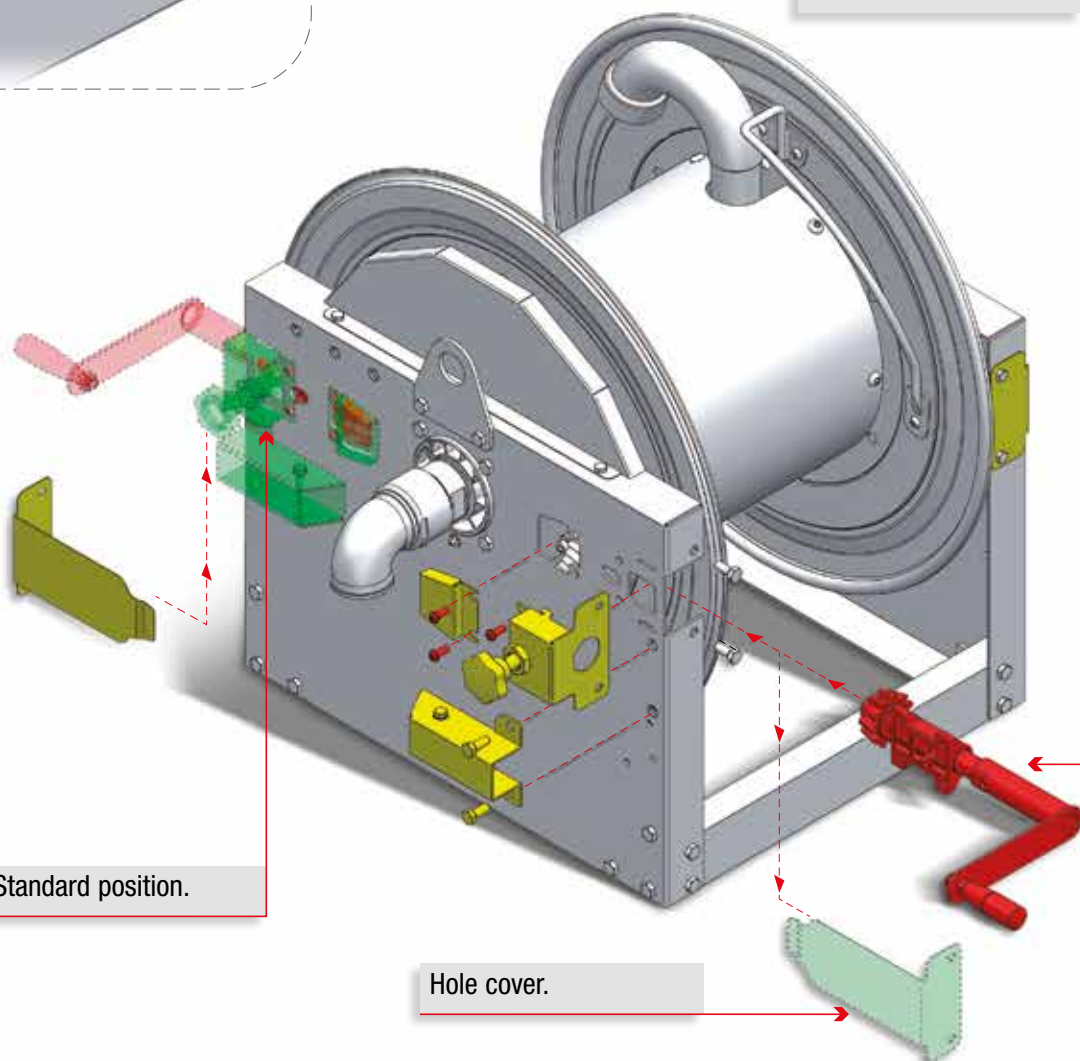

New position.

Standard position.

Hole cover.



SERIES 700 ELECTRIC 24V

PAINTED STEEL

The hose reels with 24V electric motor are a handy and easy answer to the problem of hose management. Hose unwinding occurs manually whereas rewinding is done with the electric motor connected to a battery or an electrical transformer.



	width 270 mm	width 410 mm	width 550 mm	width 690 mm	Connection	
					inlet	outlet
20 bar Air - Water Diesel fuel - swivel joint aluminium - seals in Viton®	7721301.100	7741301.100	7751301.100	7771301.100	2"	2"
70 bar Oil and allied products - swivel joint in carbon steel - seals in Viton®	7721301.400	7741301.400	7751301.400	7771301.400	2"	2"

DRUM CAPACITY					
Ø HOSE	Ø HOSE EXT.	L270	L410	L550	L690
3/8"	17 mm	160 m	290 m	420 m	550 m
1/2"	20 mm	110 m	180 m	280 m	350 m
3/4"	27 mm	65 m	120 m	180 m	244 m
1"	34 mm	30 m	60 m	100 m	134 m
1.1/4"	43 mm	20 m	35 m	60 m	84 m
1.1/2"	50 mm	15 m	30 m	50 m	75 m
2"	63 mm	10 m	20 m	30 m	43 m

OVERALL DIMENSIONS

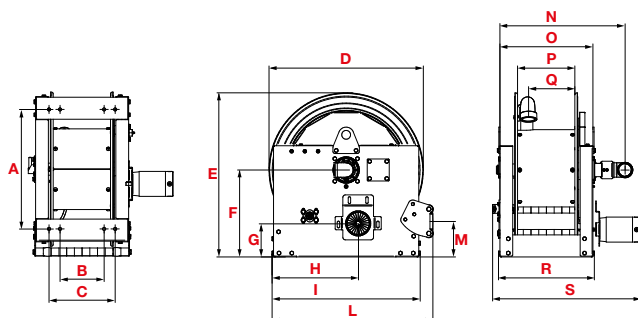

24V electric hose reel power supply

The 24V motor can be connected to a battery or a current transformer connected to the 230V mains. An On/Off switch must be installed between the power supply and the hose reel.

24V DC MOTOR, 300W POWER

⚠ Attention: check the electrical connection for the correct direction of motor rotation.

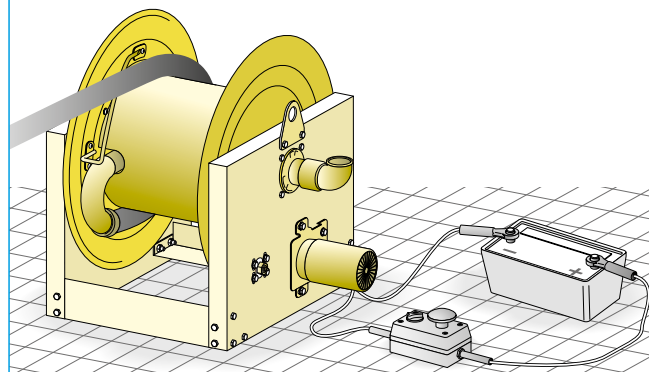

P/N	A	B	C	D	E	F	G	H	I	L	M	N	O	P	Q	R	S	1-m ³	Kg
L 270	542	200	300	700	760	410	150	390	670	730	160	570	422	260	210	435	630	0,53	100
L 410	542	340	440	700	760	410	150	390	670	730	160	712	562	398	350	575	770	0,63	110
L 550	542	480	580	700	760	410	150	390	670	730	160	850	705	538	490	717	915	0,73	117
L 690	542	620	720	700	760	410	150	390	670	730	160	990	842	680	630	855	1055	0,82	133



SERIES 700 ELECTRIC 230V

PAINTED STEEL

The hose reels with 230V electric motor are a handy and easy answer to the problem of hose management. Hose unwinding occurs manually whereas rewinding is done with the electric motor appropriately connected to the 230V power supply.

On request hose reels are available with following Atex Certification



	width 270 mm	width 410 mm	width 550 mm	width 690 mm	Connection	
					inlet	outlet
20 bar Air - Water Diesel fuel - swivel joint aluminium - seals in Viton®	7721601.100	7741601.100	7751601.100	7771601.100	2"	2"
70 bar Oil and allied products - swivel joint in carbon steel - seals in Viton®	7721601.400	7741601.400	7751601.400	7771601.400	2"	2"

DRUM CAPACITY					
Ø HOSE	Ø HOSE EXT.	L270	L410	L550	L690
3/8"	17 mm	160 m	290 m	420 m	550 m
1/2"	20 mm	110 m	180 m	280 m	350 m
3/4"	27 mm	65 m	120 m	180 m	244 m
1"	34 mm	30 m	60 m	100 m	134 m
1.1/4"	43 mm	20 m	35 m	60 m	84 m
1.1/2"	50 mm	15 m	30 m	50 m	75 m
2"	63 mm	10 m	20 m	30 m	43 m

OVERALL DIMENSIONS

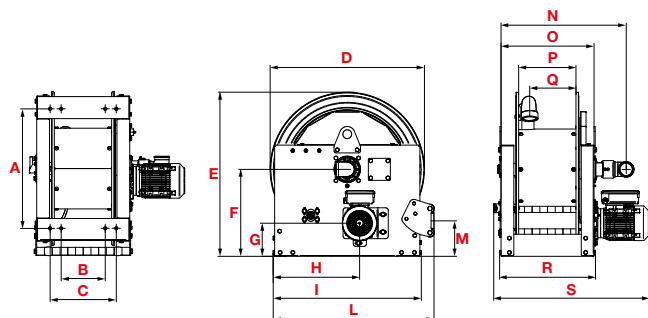

230V electric hose reel power supply

The On/Off push button must be installed **between the electric motor and 230V power supply**. An internal reduction unit allows the hose to be correctly wound on the drum.

SINGLE-PHASE 230V DC MOTOR, 370W POWER AND CONDENSER TO INCREASE INITIAL INRUSH

⚠ Attention: check the electrical connection for the correct direction of motor rotation.

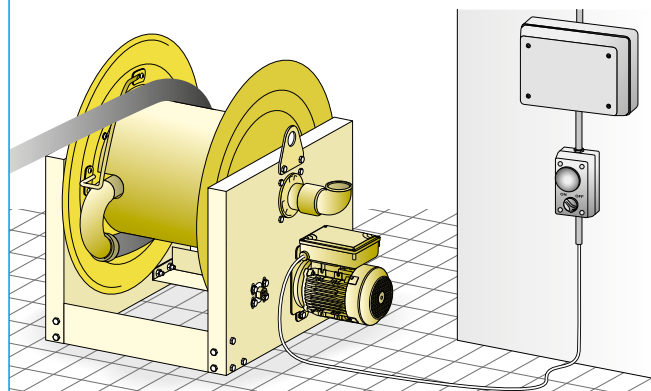

P/N	A	B	C	D	E	F	G	H	I	L	M	N	O	P	Q	R	S	1-m ³	Kg
L 270	542	200	300	700	760	410	150	390	670	730	160	570	422	260	210	435	680	0,53	102
L 410	542	340	440	700	760	410	150	390	670	730	160	712	562	398	350	575	844	0,63	113
L 550	542	480	580	700	760	410	150	390	670	730	160	850	705	538	490	717	965	0,73	120
L 690	542	620	720	700	760	410	150	390	670	730	160	990	842	680	630	855	1100	0,82	136



SERIES 700 HYDRAULIC PAINTED STEEL

The hose reels with hydraulic motor are a handy and easy answer to the problem of hose management. Hose unwinding occurs manually whereas rewinding is done with the hydraulic motor connected to a special control unit as indicated in the figure below.



	width 270 mm	width 410 mm	width 550 mm	width 690 mm	Connection	
					inlet	outlet
20 bar Air - Water Diesel fuel - swivel joint aluminium - seals in Viton®	7721801.100	7741801.100	7751801.100	7771801.100	2"	2"
70 bar Oil and allied products - swivel joint in carbon steel - seals in Viton®	7721801.400	7741801.400	7751801.400	7771801.400	2"	2"

DRUM CAPACITY					
Ø HOSE	Ø HOSE EXT.	L270	L410	L550	L690
3/8"	17 mm	160 m	290 m	420 m	550 m
1/2"	20 mm	110 m	180 m	280 m	350 m
3/4"	27 mm	65 m	120 m	180 m	244 m
1"	34 mm	30 m	60 m	100 m	134 m
1.1/4"	43 mm	20 m	35 m	60 m	84 m
1.1/2"	50 mm	15 m	30 m	50 m	75 m
2"	63 mm	10 m	20 m	30 m	43 m

OVERALL DIMENSIONS

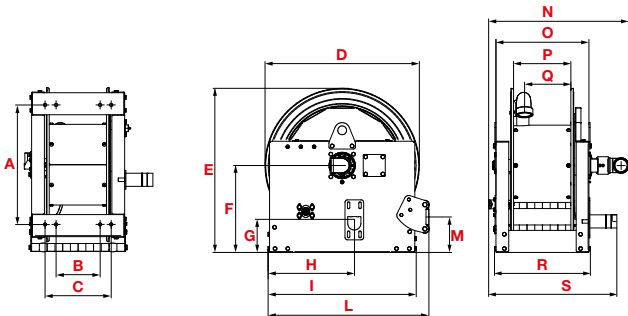

Hydraulic hose reel feed

The hydraulic motor must be connected to a special control unit equipped with a pump with electric motor, hydraulic oil tank and a control system operated by the user to rewind the hose.

HYDRAULIC MOTOR, OIL PRESSURE MAX. 170 BAR
FOR A FEED OF 5 L/MIN

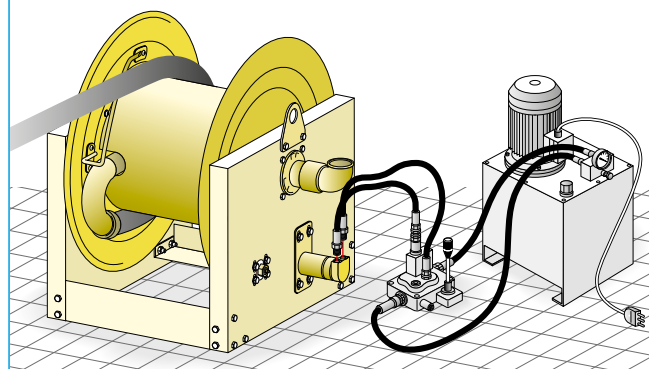

P/N	A	B	C	D	E	F	G	H	I	L	M	N	O	P	Q	R	S	1-m ³	Kg
L 270	542	200	300	700	760	410	150	390	670	730	160	640	422	260	210	435	555	0,53	91
L 410	542	340	440	700	760	410	150	390	670	730	160	782	562	398	350	575	695	0,63	102
L 550	542	480	580	700	760	410	150	390	670	730	160	920	705	538	490	717	840	0,73	109
L 690	542	620	720	700	760	410	150	390	670	730	160	1060	842	680	630	855	975	0,82	125



SERIES 700 PNEUMATIC PAINTED STEEL

The hose reels with pneumatic motor are a handy and easy answer to the problem of hose management. Hose unwinding occurs manually whereas rewinding is done with the pneumatic motor connected to the compressed air supply as indicated in the figure below.

Mounting the clutch P/N 77/2F hose reels is in accordance with the Atex Certification



	width 270 mm	width 410 mm	width 550 mm	width 690 mm	Connection	
					inlet	outlet
20 bar Air - Water Diesel fuel - swivel joint aluminium - seals in Viton®	7721901.100	7741901.100	7751901.100	7771901.100	2"	2"
70 bar Oil and allied products - swivel joint in carbon steel - seals in Viton®	7721901.400	7741901.400	7751901.400	7771901.400	2"	2"

DRUM CAPACITY					
Ø HOSE	Ø HOSE EXT.	L270	L410	L550	L690
3/8"	17 mm	160 m	290 m	420 m	550 m
1/2"	20 mm	110 m	180 m	280 m	350 m
3/4"	27 mm	65 m	120 m	180 m	244 m
1"	34 mm	30 m	60 m	100 m	134 m
1.1/4"	43 mm	20 m	35 m	60 m	84 m
1.1/2"	50 mm	15 m	30 m	50 m	75 m
2"	63 mm	10 m	20 m	30 m	43 m

OVERALL DIMENSIONS

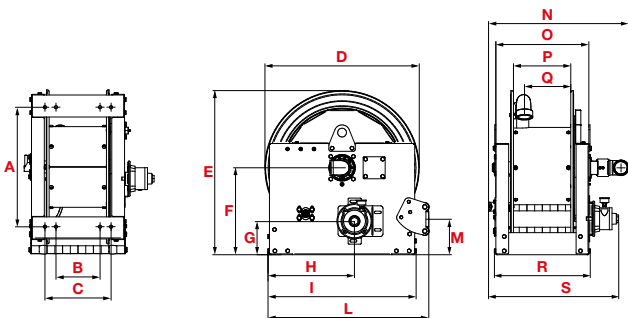

Pneumatic hose reel feed

The hose reel with pneumatic motor must be connected to the compressed air supply, interposing an open/close cock and a pressure regulator for controlling the rewinding force and speed.

PNEUMATIC MOTOR, WORKING PRESSURE
MAX. 7 BAR FOR A CONSUMPTION OF 2000 L/MIN

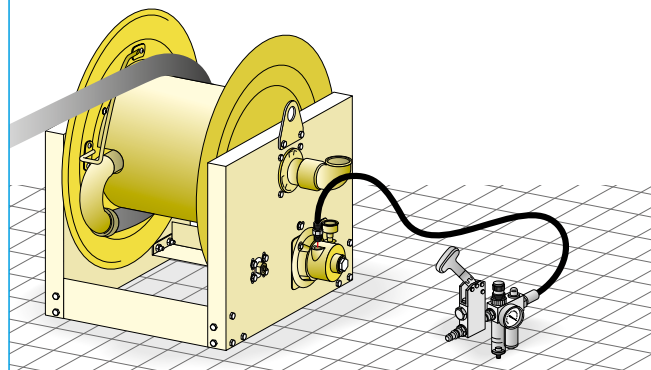

P/N	A	B	C	D	E	F	G	H	I	L	M	N	O	P	Q	R	S	1-m ³	Kg
L 270	542	200	300	700	760	410	150	390	670	730	160	640	422	260	210	435	565	0,53	98
L 410	542	340	440	700	760	410	150	390	670	730	160	782	562	398	350	575	700	0,63	109
L 550	542	480	580	700	760	410	150	390	670	730	160	920	705	538	490	717	845	0,73	116
L 690	542	620	720	700	760	410	150	390	670	730	160	1060	842	680	630	855	985	0,82	131



Accessories hose guide on request

Manual operation hose guide, high

P/N 77/22775B for width 270 mm
P/N 77/24175B for width 410 mm
P/N 77/25575B for width 550 mm
P/N 77/26975B for width 690 mm

Using the special knob, the operator shifts the hose to the right or left to ensure its correct rewinding.

Manual operation hose guide, low

P/N 77/22775 for width 270 mm
P/N 77/24175 for width 410 mm
P/N 77/25575 for width 550 mm
P/N 77/26975 for width 690 mm

Hose guide standard closed, high

P/N 77/12775B for width 270 mm
P/N 77/14175B for width 410 mm
P/N 77/15575B for width 550 mm
P/N 77/16975B for width 690 mm

Hose guide with rollers that ensure easy sliding of the hose during unwinding and rewinding.

Hose guide standard closed, low

P/N 77/12775 for width 270 mm
P/N 77/14175 for width 410 mm
P/N 77/15575 for width 550 mm
P/N 77/16975 for width 690 mm

Hose guide standard open, high

P/N 77/32775B for width 270 mm
P/N 77/34175B for width 410 mm
P/N 77/35575B for width 550 mm
P/N 77/36975B for width 690 mm

Hose guide standard open, low

P/N 77/32775 for width 270 mm
P/N 77/34175 for width 410 mm
P/N 77/35575 for width 550 mm
P/N 77/36975 for width 690 mm

Hose guide, standard open high or low.
This type of hose guide enables fitting of both versions (high and low) on the same hose reel, allowing hose unwinding in two opposite directions.

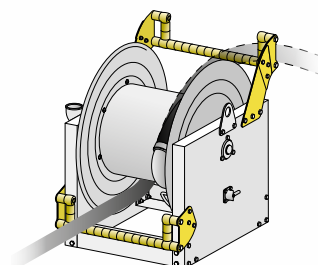
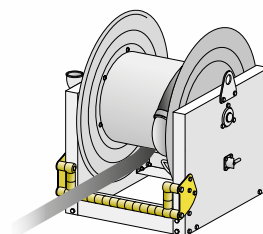
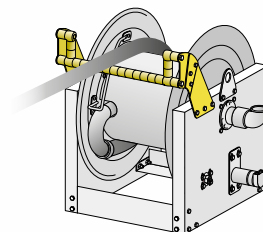
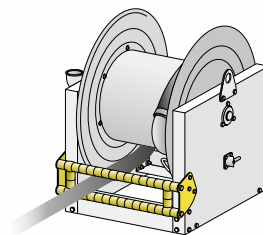
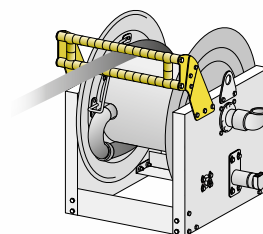
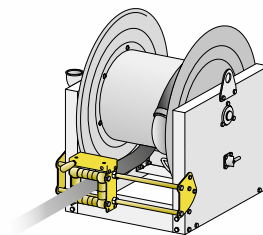
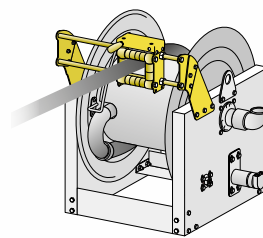



Technical characteristics **clutch** on request

Hose reel with 24V - 230V ELECTRIC - HYDRAULIC - PNEUMATIC motor

The clutch is useful during hose unwinding which is always done manually. It acts on the connection between the crown gears of the hose reel, limiting sliding. Hose unwinding speed is limited by means of the regulating knob, thereby preventing the drum from continuing to turn due to inertia.

Connection between crown gears, on which the clutch acts.

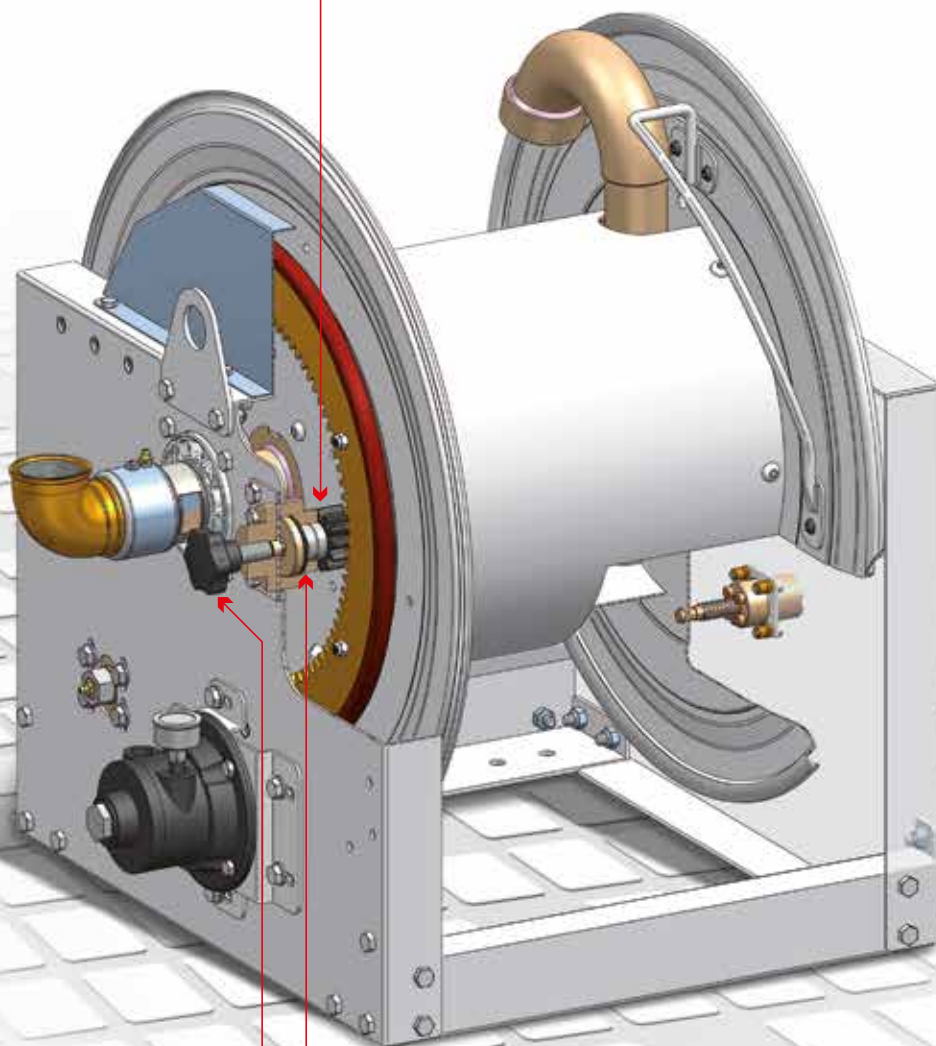

Clutch regulating knob.

P/N 77/2F Clutch

The clutch mounted on a freewheel bearing enables controlled unwinding of the hose, becoming neutral during rewinding.



24V ELECTRIC



230V ELECTRIC



HYDRAULIC



PNEUMATIC

Wall mounting

- ▶ Drill the necessary holes after choosing the ideal position, checking the solidity and thickness of the wall, marking the holes for the plugs (see template supplied with the hose reel) and ensuring that they will not pierce any plumbing pipes or electrical cables. Fix the plugs in the wall and insert the hose reel in the special seats. Tighten the 4/8 fixing nuts.

1 standard position of lifting hooks. 2 - 3 alternative positions of lifting hooks.

A - B positions of hose guides.

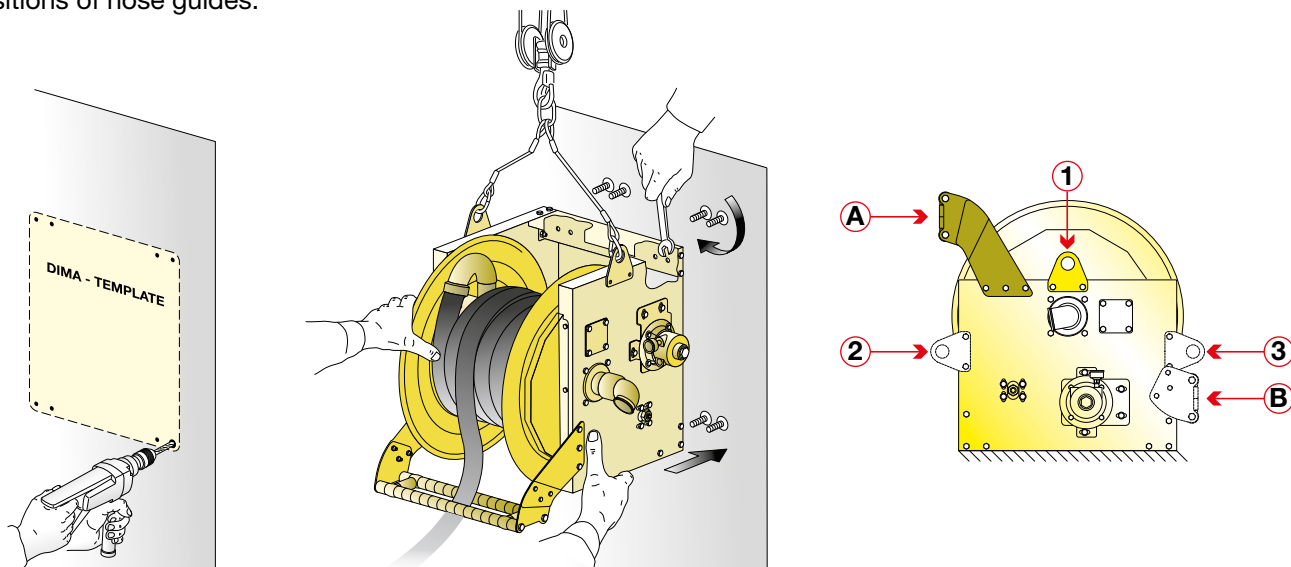

Fitting the hose

- ▶ Before fitting, make sure the hose reel drum is locked by means of the special brake **F** (see procedures 1 - 2 - 3). Screw a Nipple **N** on the outlet elbow **G**, with sealant. Fit the hose on the Nipple **N**.

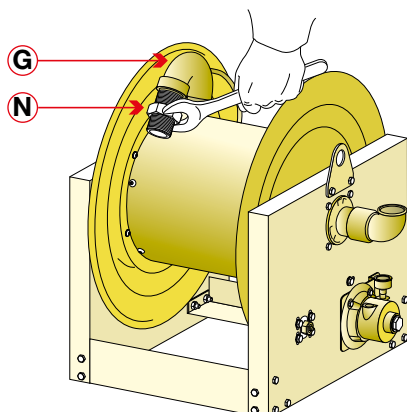
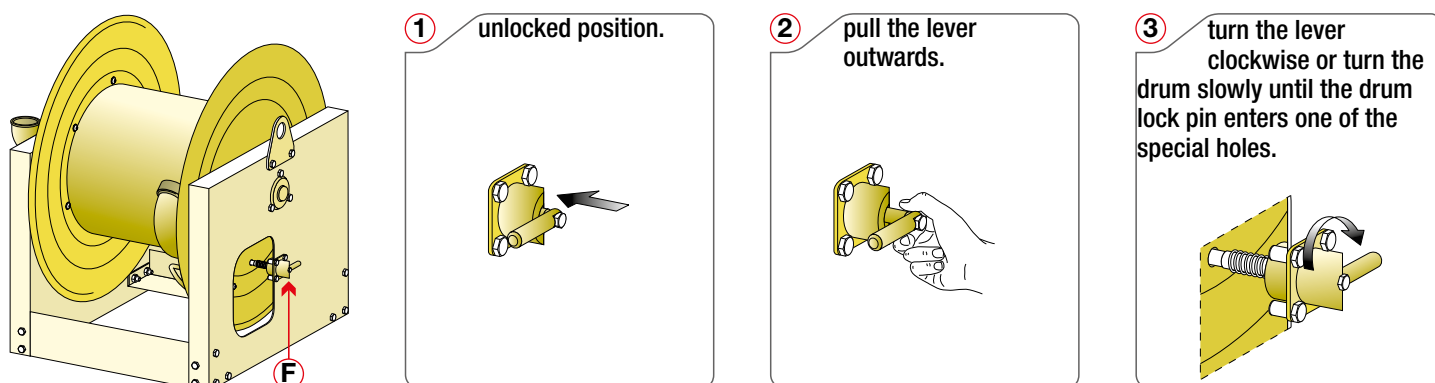

FITTING THE NIPPLE

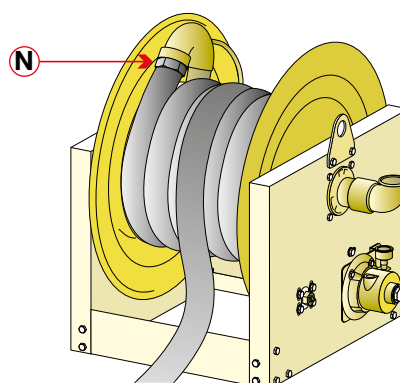

FITTING THE HOSE



RAASM has created a wide range of industrial hose reels to meet the most complex needs in various application sectors such as: industry, agriculture, depots and refineries, mining, aviation, shipyards, fire brigades, automotive, etc.

EXAMPLES of use

industry, agriculture, depots and refineries,
mining, aviation, shipyards, fire brigades,
automotive, etc.

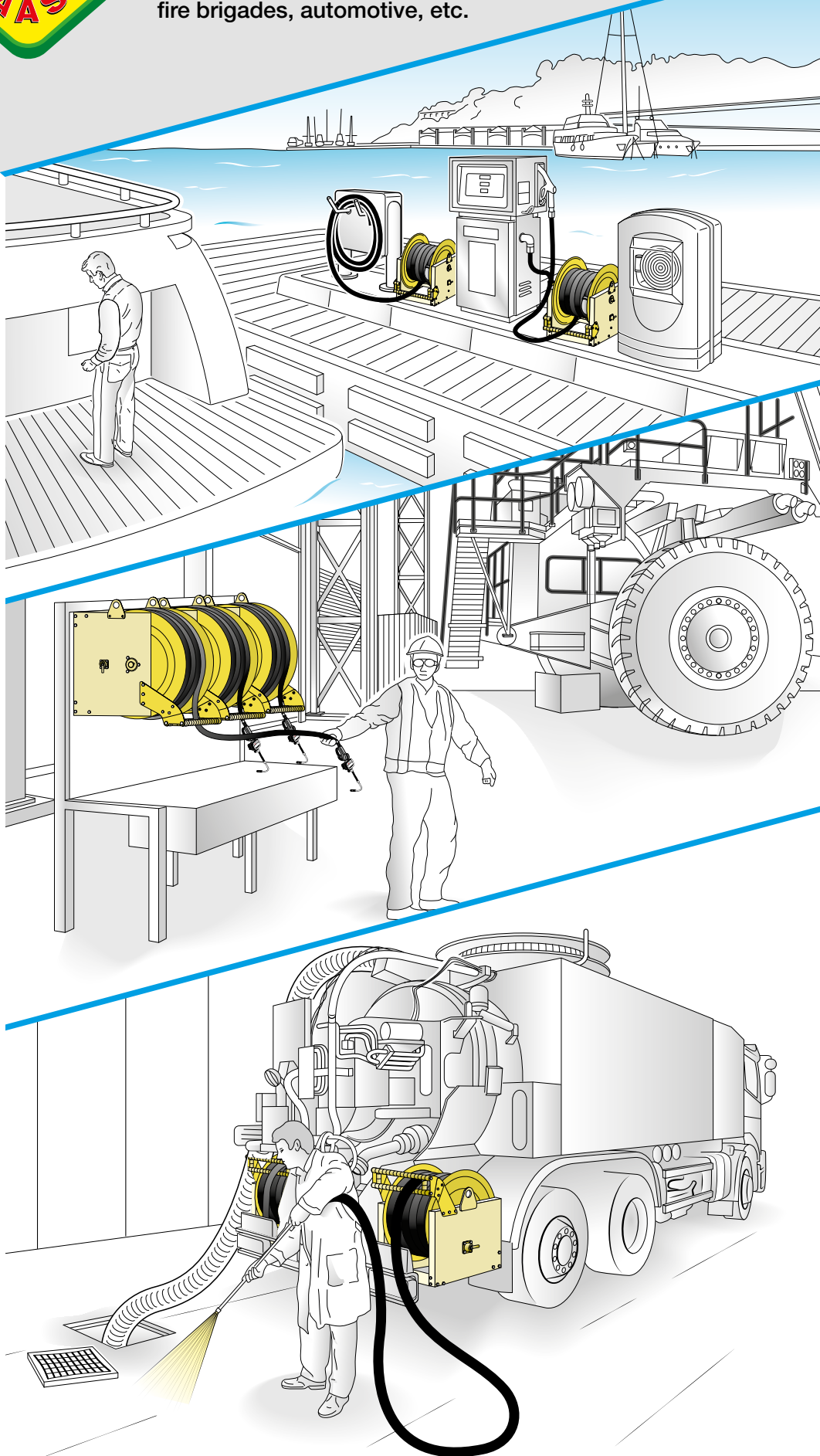



ADVANCED FLUID MANAGEMENT SOLUTIONS

technology, quality, functionality

The starting point for the entire production cycle is the research and development of cutting-edge new solutions which lead to the development of **high quality products, fully produced in Italy.**

The quality of our product manufacturing has always been our absolute priority. To reach this goal rigorous testing accompanies every phase of the manufacturing process.

RAASM offers the most complete range of lubrication products suited to many sectors. Our aim is to always be available to provide solutions to our customers.



Company with quality and environment system according to ISO 9001:2015 and ISO 14001:2015 standards

RAASM S.p.A.
36022 S. ZENO DI CASSOLA (VI)
Via Marangoni, 33 - ITALY

Export department

Tel. +39 0424 571130 - Fax +39 0424 571135

Technical department

Tel. +39 0424 571150 - Fax +39 0424 571155

info@raasm.com - www.raasm.com



WRCA220/700-GB

Authorized distributor